

enr311 11/06/03 12:24:03

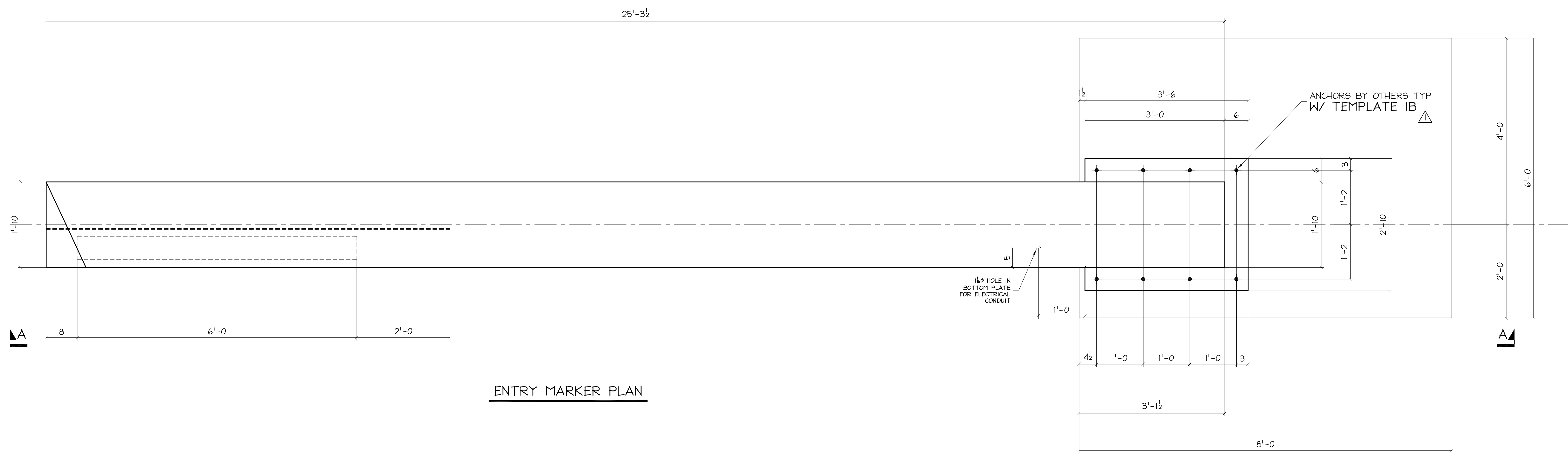

ENTRY MARKER PLAN

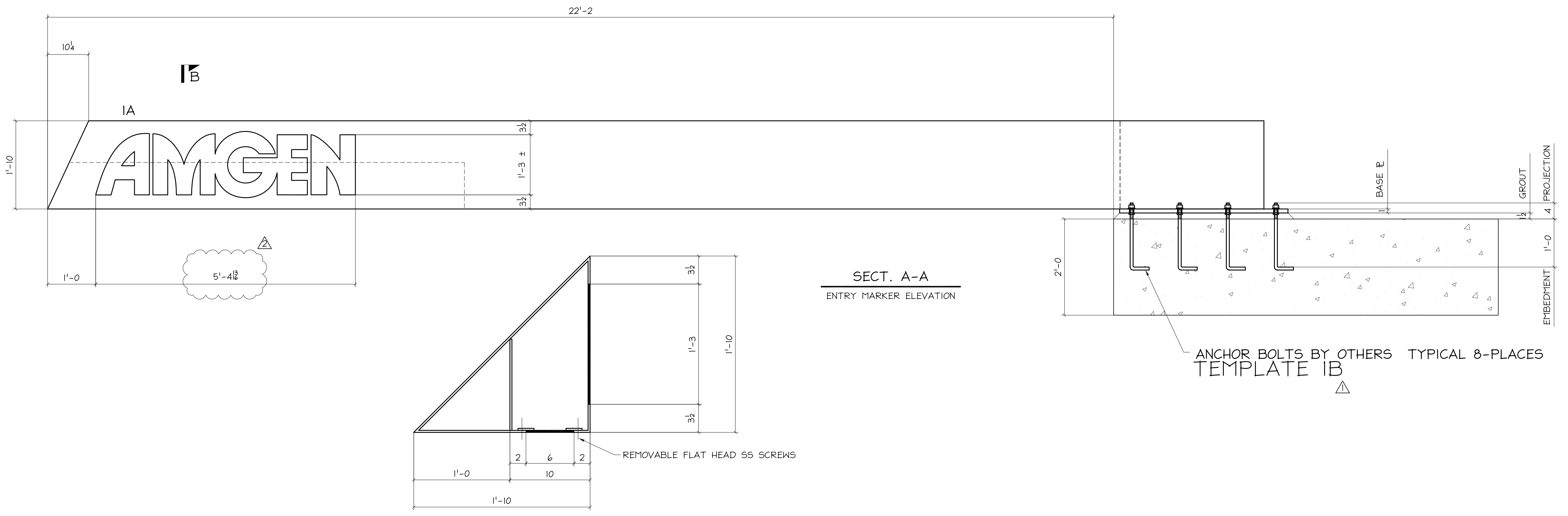

SECT. A-A
ENTRY MARKER ELEVATION

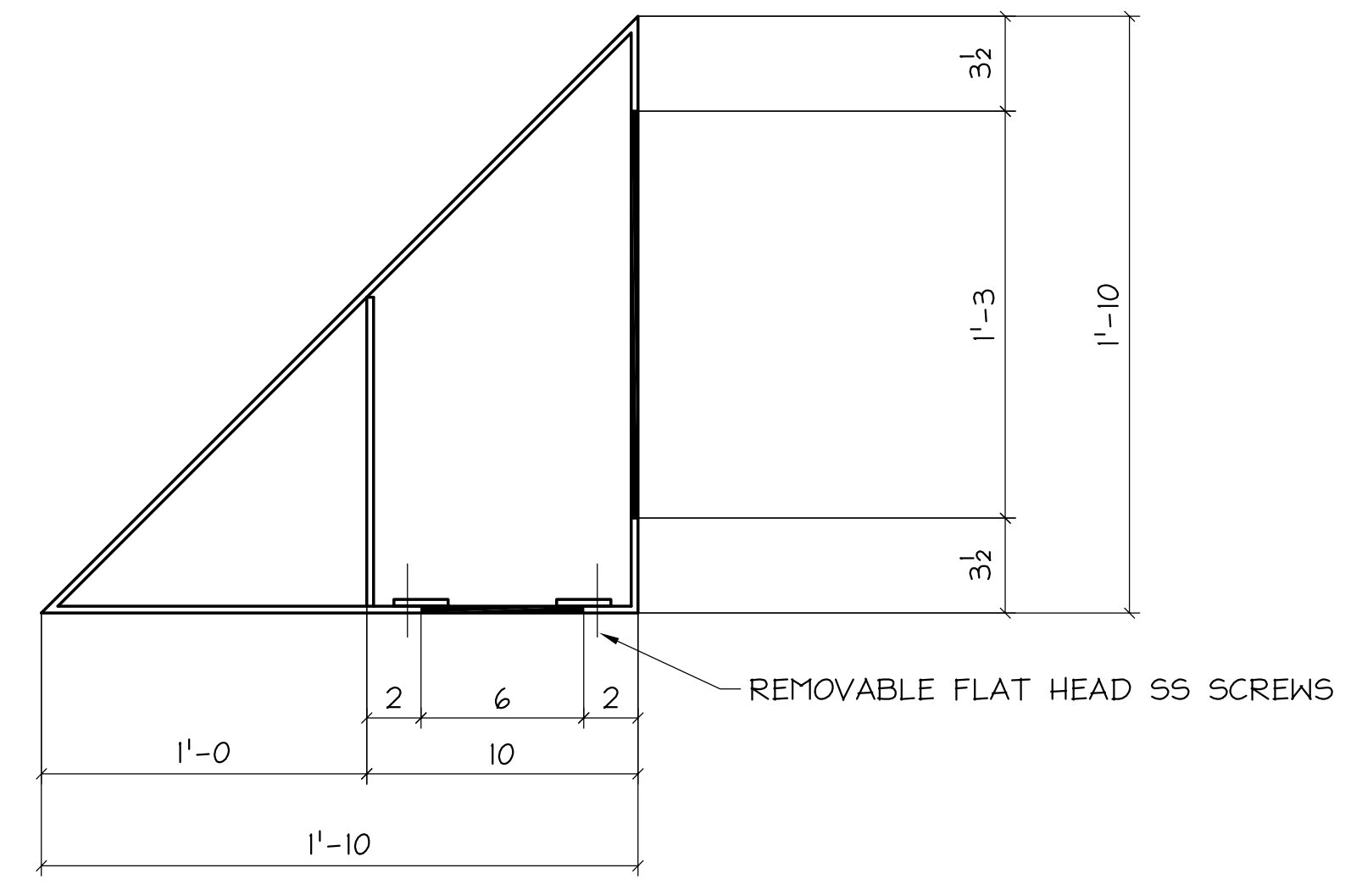

SECT-B

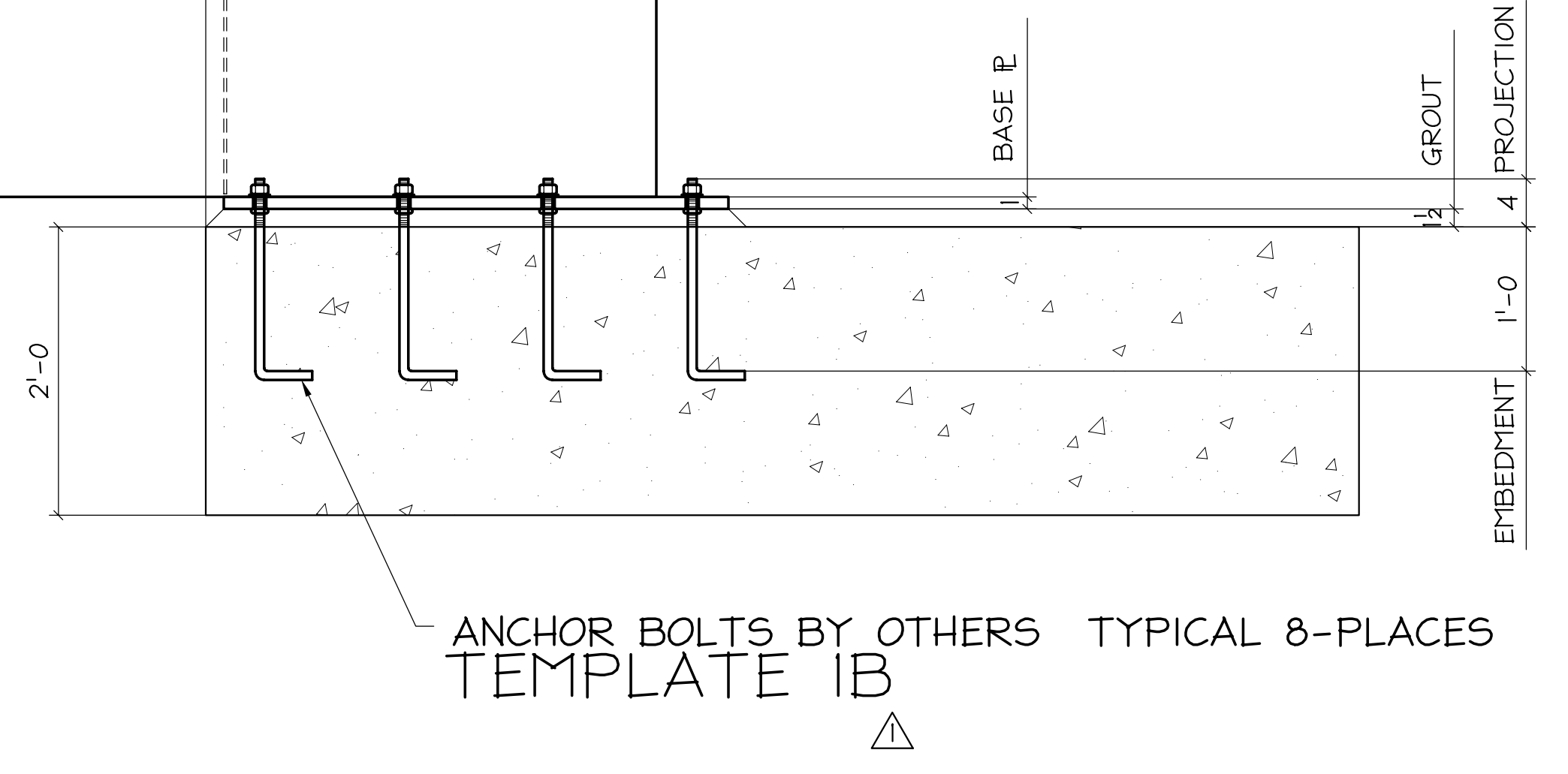

ANCHOR BOLTS BY OTHERS TYPICAL 8-PLACES
TEMPLATE IB

VERIFICATION OF DIMENSIONS, DETAILS, AND ETC. ARE REQUESTED WHERE INDICATED. IF EACH VERIFICATION IS NOT NOTED OTHERWISE, IT WILL BE ASSUMED TO BE CORRECT AS SHOWN

REV	DATE	BY	DESCRIPTION	DWG STATUS	DATE
2	11/10/03	GA	UPDATE LOGO / ISSUE FOR FABRICATION		
1	11/6/03	GA	IFF - TEMPLATE ONLY		

HELIX PROJECT
ENTRY MARKER
SEATTLE, WASHINGTON

ENGR: **kpf** ADI / ANGLE DETAILING, INC.
CONTR: ADI JOB# 2003-317

COLUMBIA WIRE & IRON WORKS
5555 N. Channel Portland, Ore. 97217
www.cwiil.com/503-286-6600

DRAWN BY: **ga** CHKD BY: **GBA** JOB NO. **67-004001** DWG. NO. **E1**

A:\2003-317\ADI_S\B\TALS...RECD\03-1122203-CURRENT\11.DWG 12/24/03 9:45am E:\0304.meliss