

A:\2003-317A-01-Submittals-REC096-1322003-CURRENT\2.DWG 12/24/03 9:45am E:\BPA.mefusa  
 email: info@angle-detailing.com

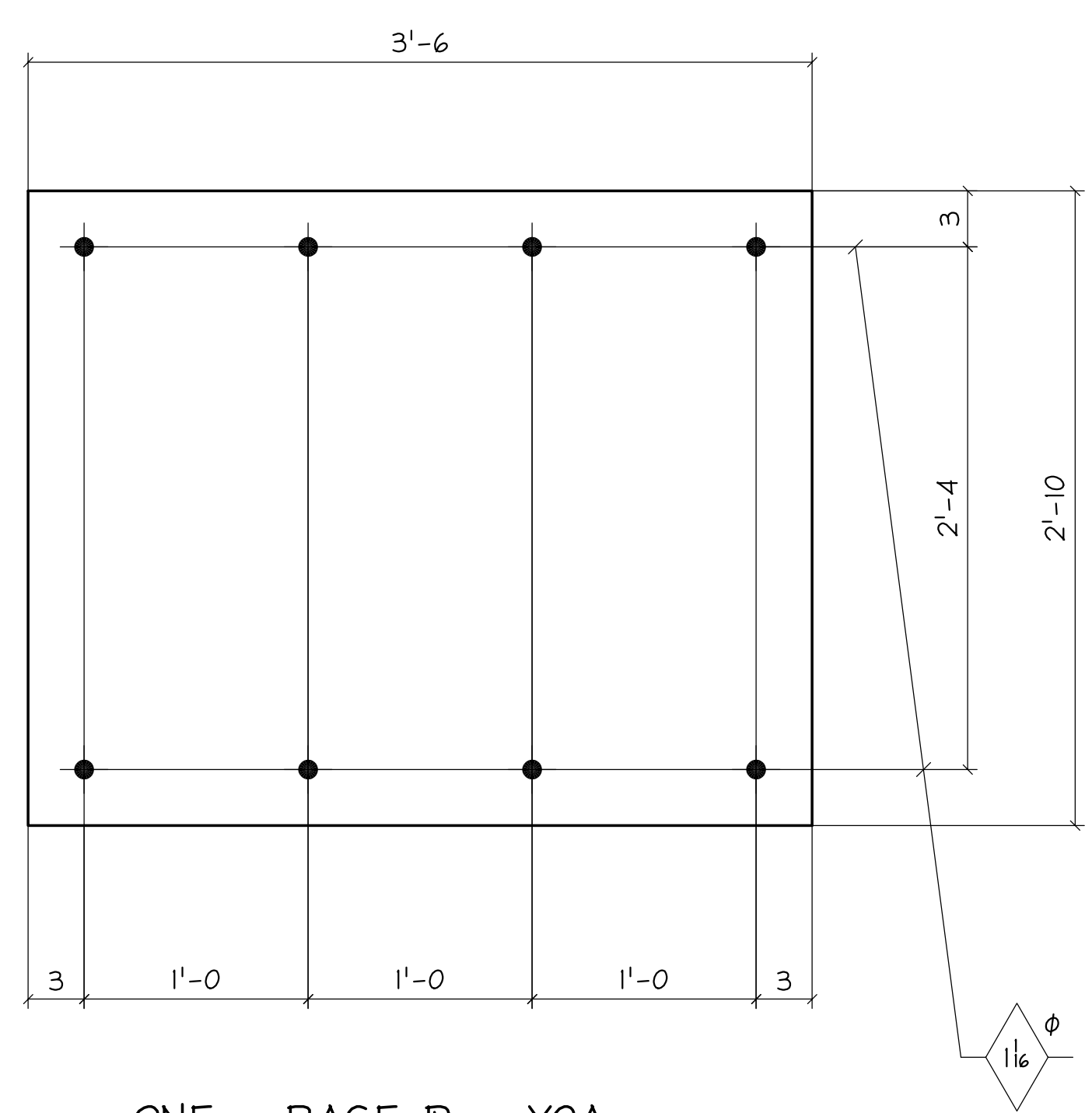

**ONE ~ BASE PLATE ~ X2A**  
NO FINISH

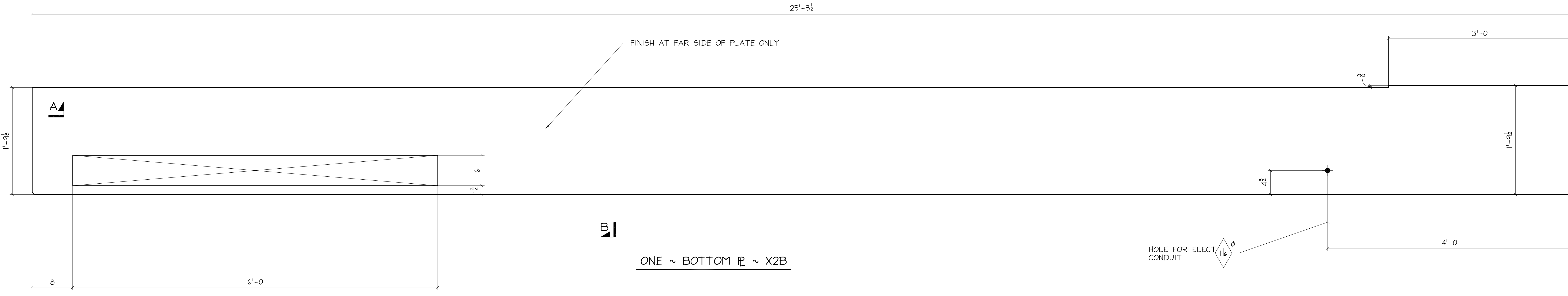

**ONE ~ BOTTOM PLATE ~ X2B**

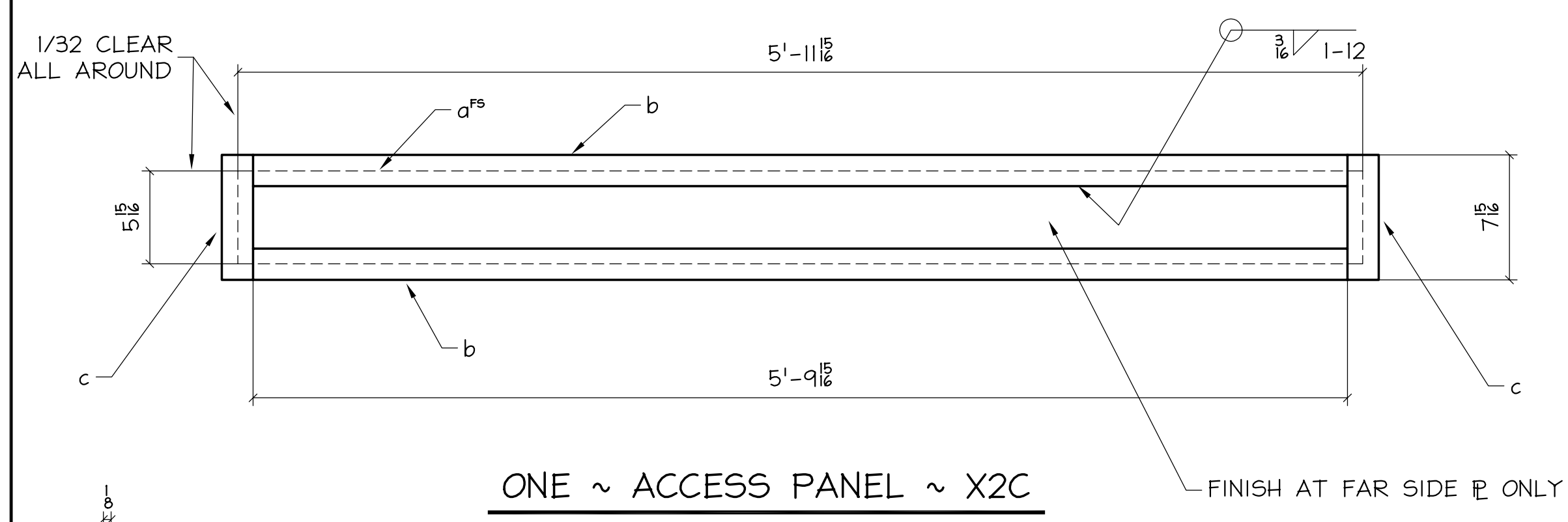

**ONE ~ ACCESS PANEL ~ X2C**

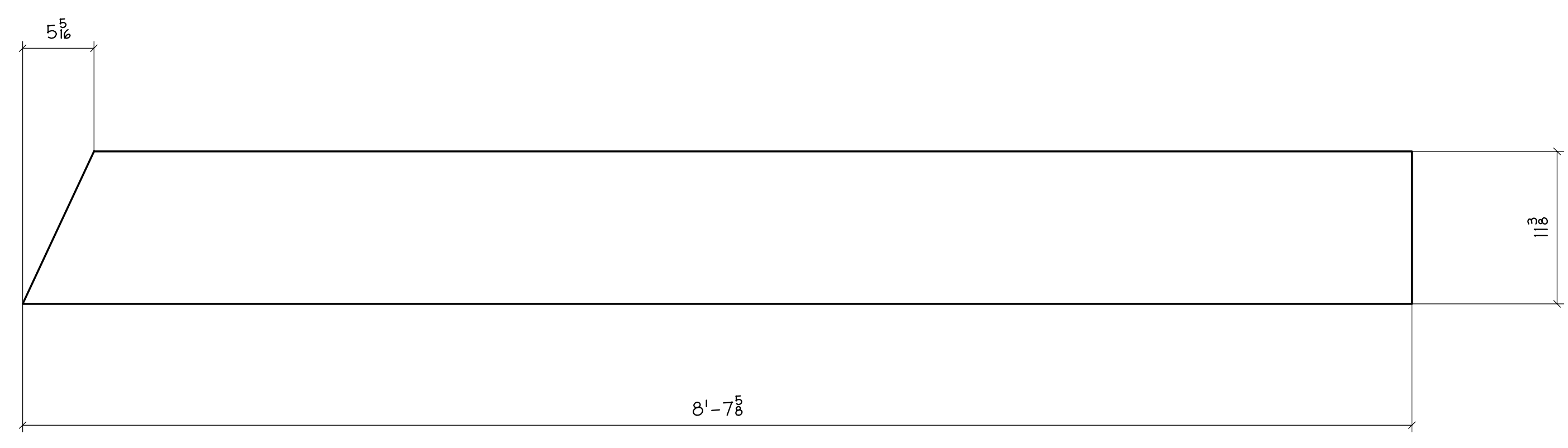

**ONE ~ INTERNAL STIFFENER ~ X2D**  
NO FINISH

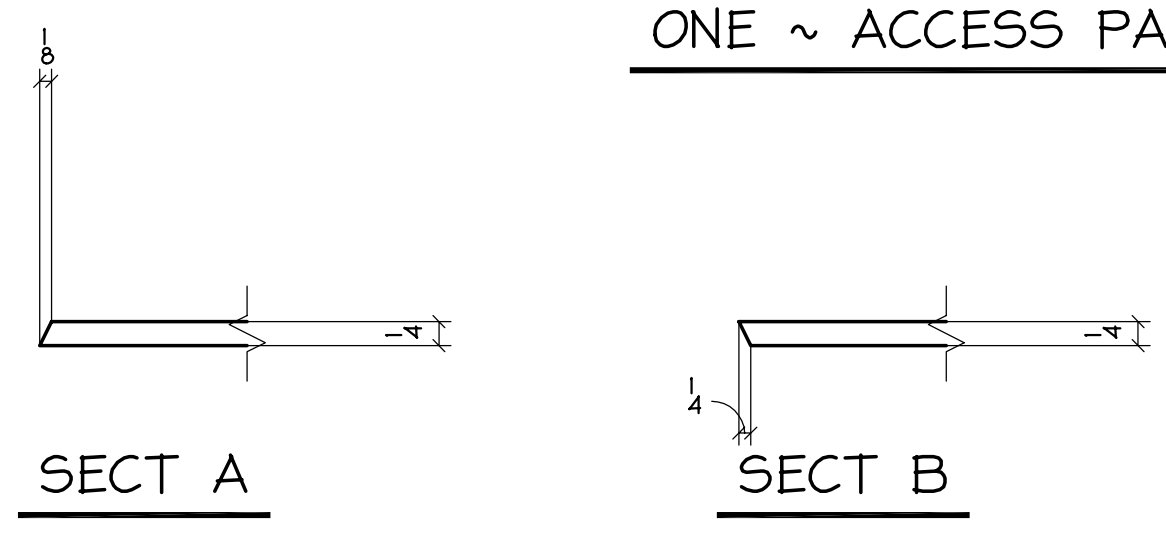

**BILL OF MATERIAL**

**BILL OF MATERIAL**

NO.	SHIP MARK	TOTAL	PC MARK	DESCRIPTION	LENGTH		REMARKS	ADV. BIL.	WEIGHT		NO.	SHIP MARK	TOTAL	PC MARK	DESCRIPTION	LENGTH		REMARKS	ADV. BIL.	WEIGHT			
					FT.	IN.			UNIT	TOTAL						FT.	IN.			UNIT	TOTAL		
1		1	X2A	PL x 34	3	6	NO FINISH																
1		1	X2B	PL x 21 1/2	25	3 1/2																	
1		1	X2C	ACCESS PANEL																			
1		1	a	PL x 5 1/8	5	11 1/8																	
1		1	b	PL x 2	5	9 1/8																	
1		1	c	PL x 2	0	7 1/8																	
1		1	X2D	PL x 11 1/8	8	7 1/8	NO FINISH																

**FABRICATION NOTES:**

HOLES UNO:  
 WELD:  
 REF DWG: I  
 MATERIAL UNO: GRADE 304 STAINLESS

**PAINT:**

NOTES: FINISH: RANDOM ORBITAL (UNO)  
 W/ CLEAR COAT

VERIFICATION OF DIMENSIONS, DETAILS, AND ETC. ARE REQUESTED, WHERE INDICATED. IF EACH VERIFICATION IS NOT NOTED OTHERWISE, IT WILL BE ASSUMED TO BE CORRECT AS SHOWN.

FOR FABRICATION	
FOR FABRICATION	
FOR PURCHASING	
FOR APPROVAL	

REV	DATE	BY	DESCRIPTION	DWG STATUS	DATE
1	11/10/03	ga	UPDATE FINISH / ISSUE FOR FABRICATION		

**HELIX PROJECT**  
 ENTRY MARKER PYLON  
 SEATTLE, WASHINGTON

ENGR: **kpf** ADI / ANGLE DETAILING, INC.  
 CONTR: ADI JOB# 2003-317

**COLUMBIA WIRE & IRON WORKS**  
 5555 N. Channel Portland, Ore. 97217  
 www.cwiil.com/503-286-6600

DRAWN BY: **ga** CHKD BY: **GBA** JOB NO: **670020XX** DWG. NO: **2**